

Section II.

TM9-2815-210-34P

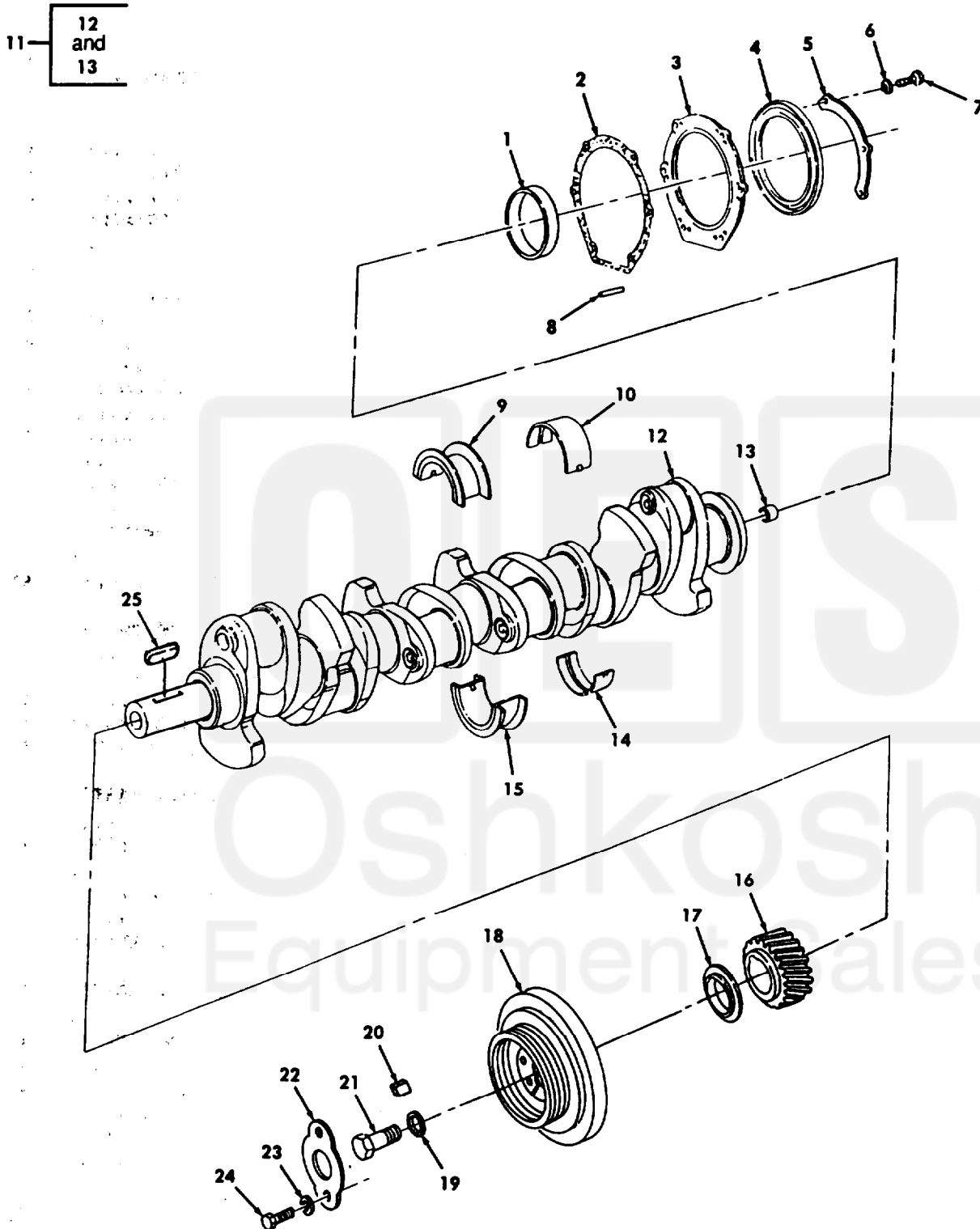

Figure 4. Crankshaft, Main Bearing, and Related Parts.

SECTION II	ITEM (1)	SMR (2)	NSN (3)	CAGEC (4)	PART NUMBER (5)	DESCRIPTION AND USABLE ON CODES (UOC) (6)	QTY (7)
	ITEM NO	CODE	NSN	CAGEC	NUMBER	DESCRIPTION AND USABLE ON CODES (UOC)	QTY
						GROUP 0102 CRANKSHAFT	
						FIG. 4 CRANKSHAFT, MAIN BEARING AND RELATED PARTS	
	1	PAHZZ	3130001779340	76680	JV1136	LINER,BEARING HOUSI	1
	2	PAFZZ	5330001224971	19207	11610019	GASKET PART OF KIT P/N 57K1319	1
	3	PAFZZ	2815009305966	19207	10889954	COVE&TIMING GEAR,I	1
	4	PAFZZ	5330009180595	19207	10951177	SEAL,PLAIN ENCASED PART OF KIT P/N 57K1319	1
	5	PAFZZ	5340008883396	02978	11610040	LOCKING PLATE,NUT A USE WITH ALUMINUM HOUSING ONLY	2
	6	PAFZZ	5310009594679	96906	MS35340-45	WASHER,LOCK	6
	7	PAFZZ	5305002259081	81337	5-4-1304-98	SCREW,CAP,HEXAGON H	6
	8	PAHZZ	5315000103736	21450	103736	PIN,STRAIGHT,HEADLE	2
	9	KFHZZ		19207	10889812	BEARING HALF THRUST,STANDARD PART OF KIT P/N 5702645	1
	9	KFHZZ		19207	10899011	BEARING HALF THRUST,0.010 UNDERSIZE PART OF KIT P/N 5702652	1
	9	KFHZZ		19207	10899012	BEARING HALF THRUST,0.020 UNDERSIZE PART OF KIT P/N 5702651	1
	10	KFHZZ		19207	10889945	BEARING HALF STANDARD PART OF KIT P/N 5702645	6
	10	KFHZZ		19207	10899015	BEARING HALF 0.010 UNDERSIZE PART OF KIT P/N 5702652	6
	10	KFHZZ		19207	10899016	BEARING HALF 0.020 UNDERSIZE OF KIT P/N 5702651	6
	11	PAHHH	2815008086989	19207	12380110	CRANKSHAFT,ENGINE	1
	12	XAHZZ		19207	12380078	.CRANKSHAFT	1
	13	PAFZZ	3120000574506	19207	10935441	.BEARING,SLEEVE TRANSMISSION PILOT	1
	14	KFHZZ		19207	10889814	BEARING HALF STANDARD PART or KIT P/N 5702645	6
	14	KFHZZ		19207	10899017	BEARING HALF 0.010 UNDERSIZE PART OF KIT P/N 5702652	6
	14	KFHZZ		19207	10899018	BEARING HALF 0.020 UNDERSIZE PART OF KIT P/N 5702651	6
	15	KFHZZ		19207	10889813	BEARING HALF THRUST, STANDARD PART OF KIT P/N 5702645	1
	15	KFHZZ		19207	10899013	BEARING HALF THRUST,0.010 UNDERSIZE PART OF KIT P/N 5702652	1
	15	KFHZZ		19207	10899014	BEARING HALF THRUST,0.020 UNDERSIZE PART OF KIT P/N 5702651	1
	16	KFFZZ		19207	10889820	GEAR,HELICAL PART OF KIT P/N 5702680	1
	17	PAFZZ	2815008600561	19207	10889746	DEFLECTOR,DIRT AND	1
	18	PAFZZ	2815009184202	53591	L197070	PULLEY AND DAMPERASSE	1
	19	PAFZZ	5310008503998	19207	10889748	WASHER,FLAT	1
	20	PAHZZ	5315011538209	19207	11610011	PIN,STRAIGHT,HEADLE PART OF KIT P/N 57K1319	1
	21	PAFZZ	5306004548625	19207	10889931	BOLT,EXTERNALLY REL	1
	22	PAFZZ	2805003058279	14351	R6000200	LOCK,GASOLINE ENGIN	1
	23	PAFZZ	5310006379541	12603	23E06	WASHER, LOCK	2
	24	PAFZZ	5305001159526	80204	B1821BH038C075D	SCREW,CAP,HEXAGON H	2